

Schröder

FLEXIA FG Maxi

Side-entry with swivel fixations

Installation instructions

ENG	INSTALLATION INSTRUCTIONS	ITA	ISTRUZIONI DI INSTALLAZIONE	NLD	INSTALLATIE INSTRUCTIES	DAN	INSTALLATIONSVEJLEDNING	HUN	TELEPÍTÉSI ÚTMUTATÓ
DEU	INSTALLATIONSANLEITUNG	POL	INSTRUKCJE MONTAŻU	RUS	Инструкции по установке	RON	INSTRUCȚIUNI DE INSTALARE	CHI	安装说明
FRA	INSTRUCTIONS DE MONTAGE	SPA	INSTRUCCIONES DE INSTALACIÓN	POR	INSTRUÇÕES DE INSTALAÇÃO	SWE	INSTALLATIONSANVISNING	UKR	Інструкції з монтажу
SRP	UPUTSTVA ZA INSTALACIJU	AR	تعليمات التركيب						

LED colour code	722	727	730	830	740	840	757	957
Light source energy efficiency class - High power	E	D	C	D	C	D	C	E
Light source energy efficiency class - Mid power			A		A			

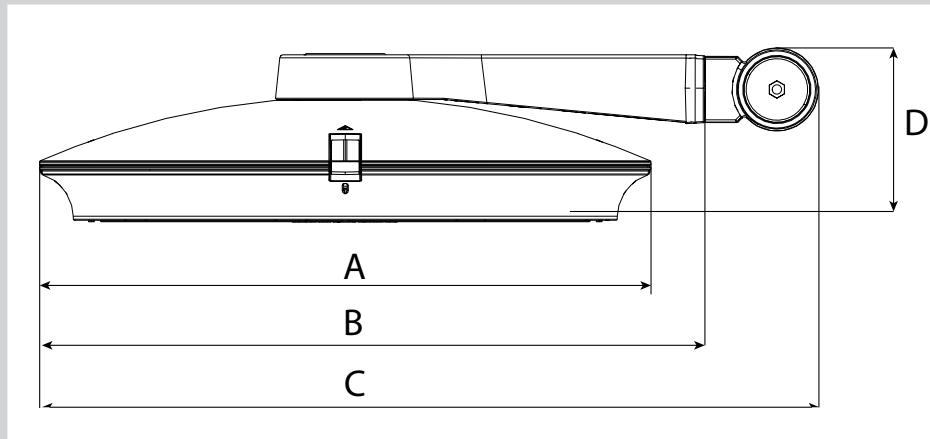

A	Ø610	Cd.S	0,102 m ²
B	168	Cs.S	0,004 m ²
C	633	Cl.S	0,102 m ²
D	737		
Kg	14,25		

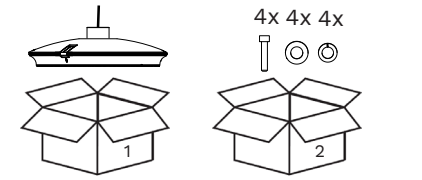

KNUCKLE JOINT ANGLES

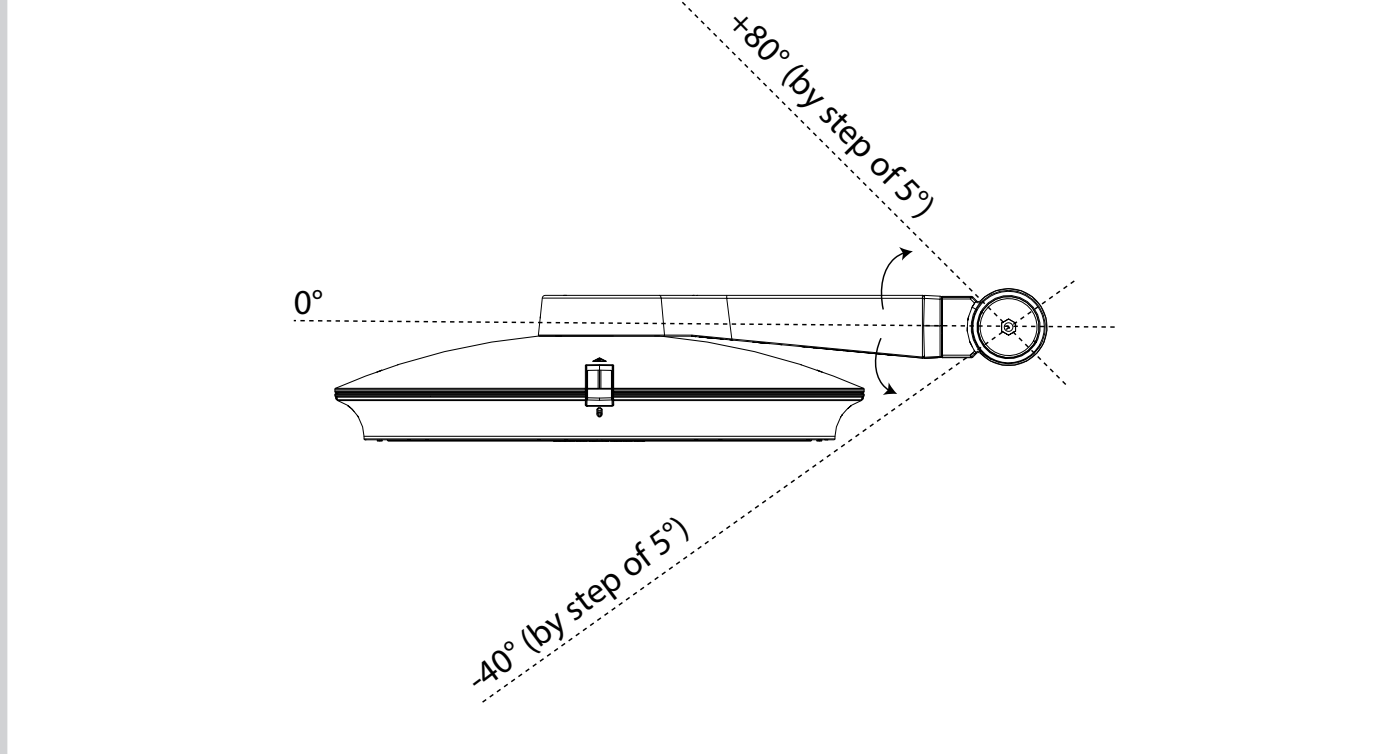

Copyright © Schröder S.A. 2022 - Executive Publisher: Stéphane Halleux - Schröder International Services S.A. - B-4000 Liège, Rue de Mons 3 (Belgium) - The information, descriptions and illustrations herein are only of an indicative nature and subject to changes without notice.

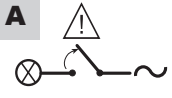

DIRECT ON SURFACE

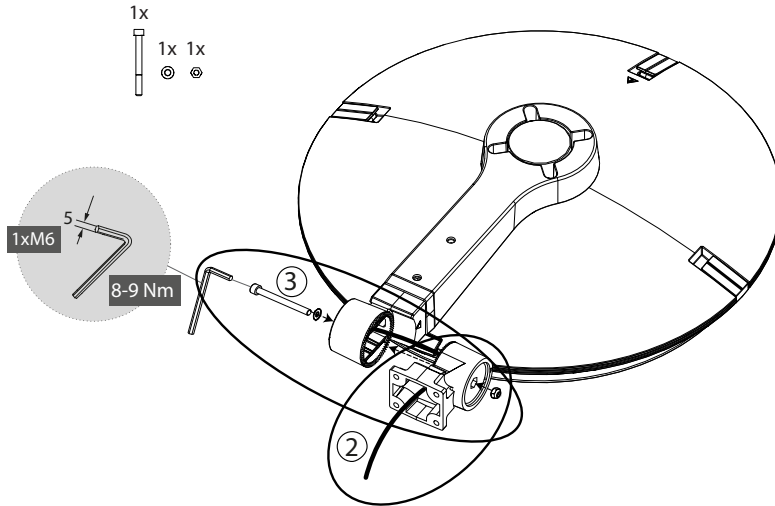
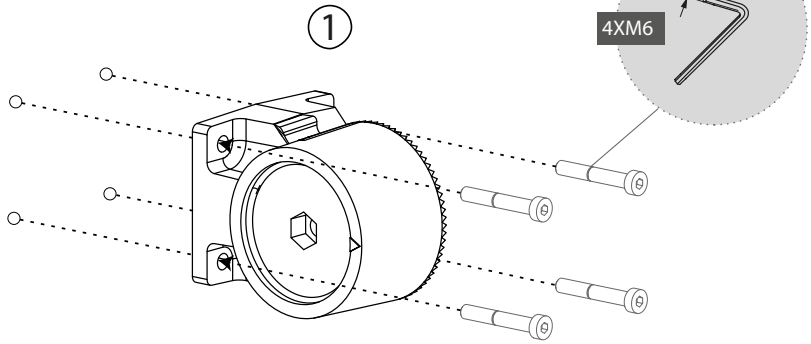
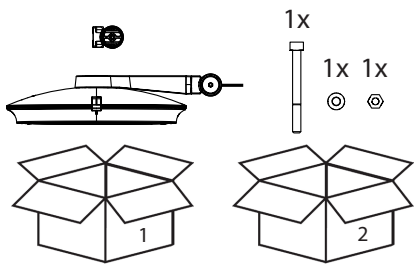

PENETRATING

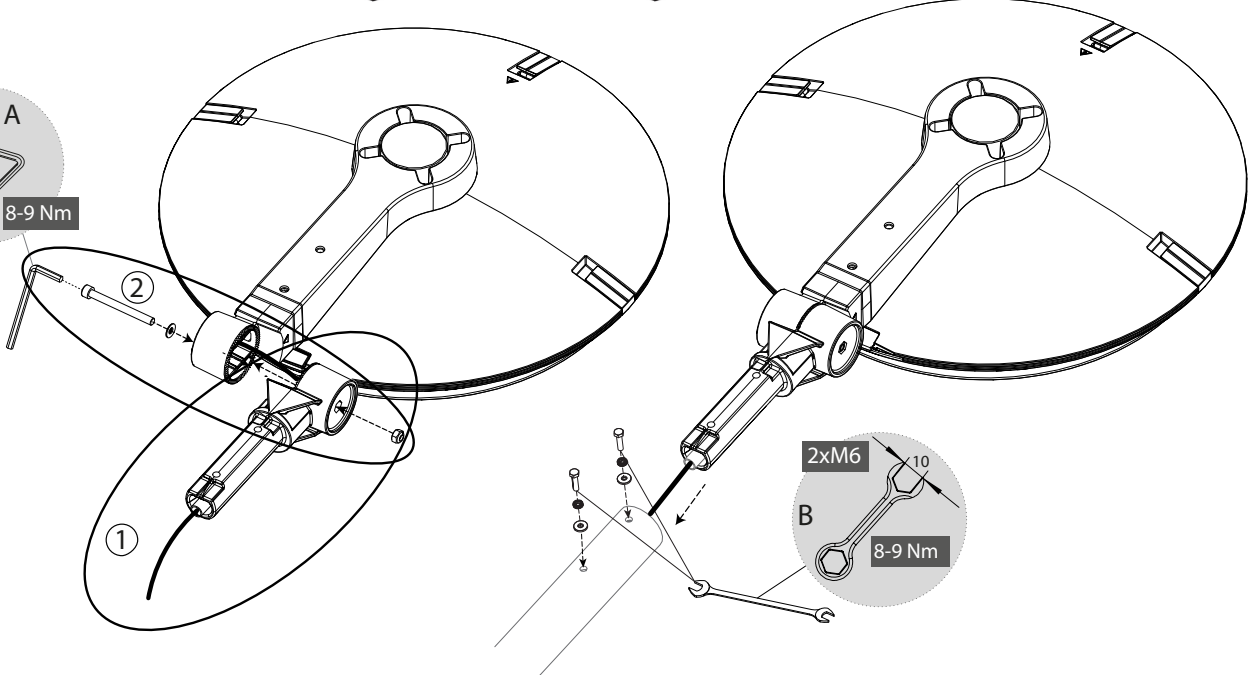
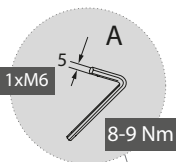
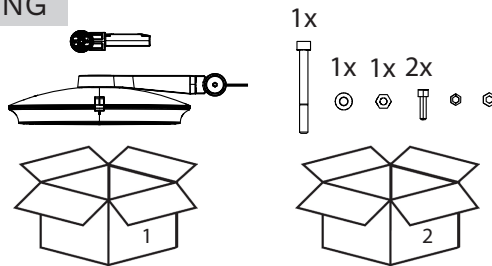



ENVELOPING

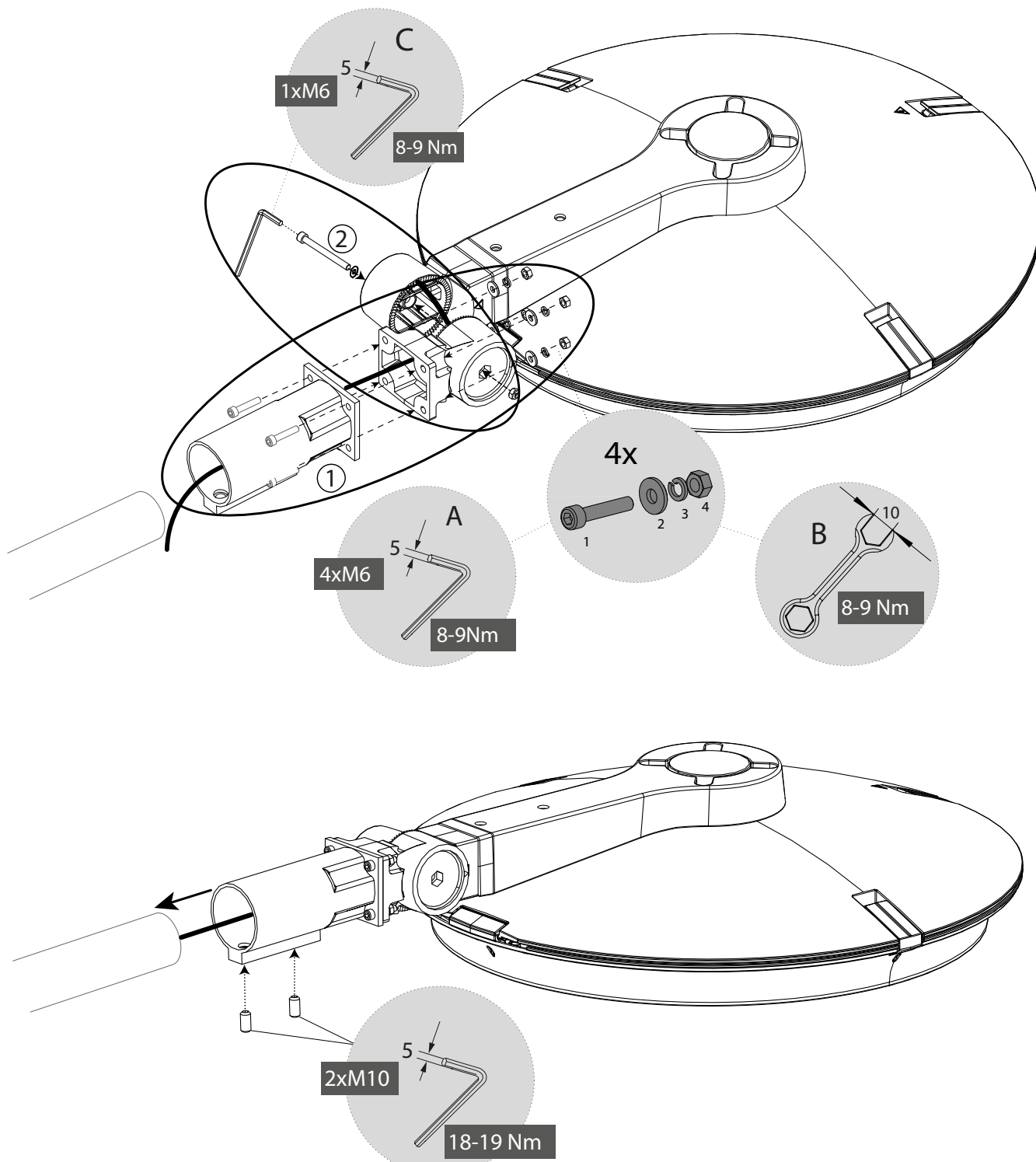
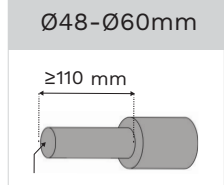
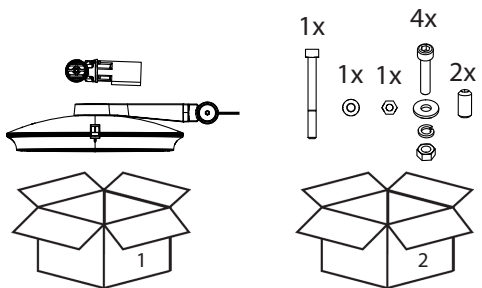

D 1" BSP - FEMALE SWIVEL

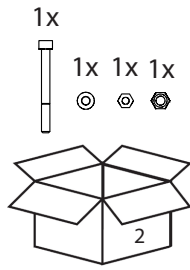
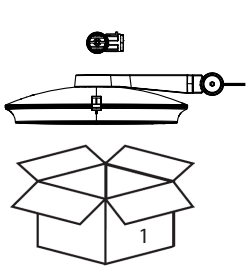
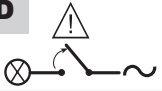

- 1x [Screw]
- 1x 1x 1x [Washer, Nut, Washer]

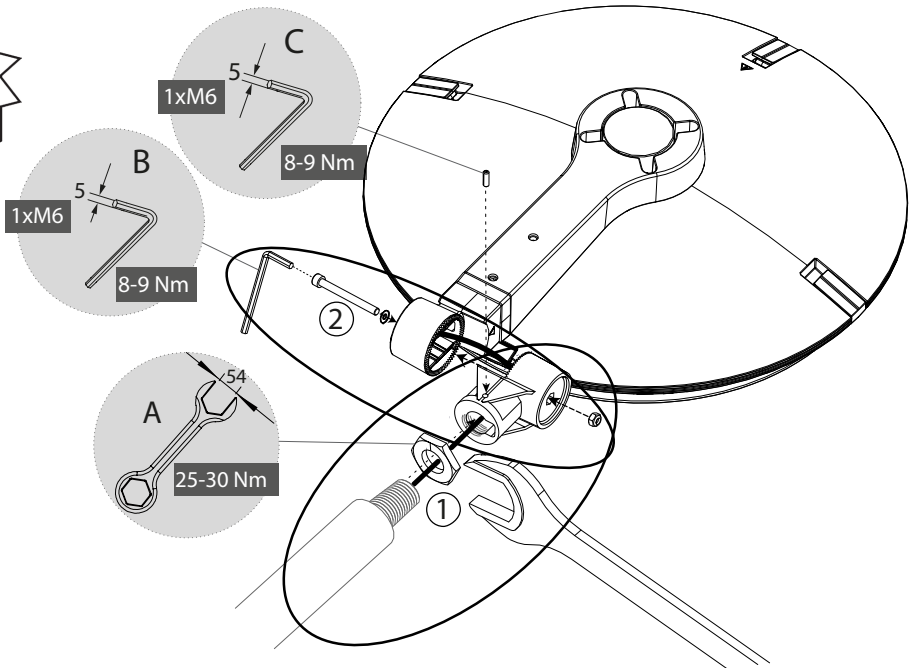

E 1" BSP - MALE SWIVEL

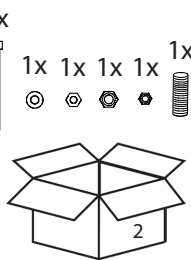
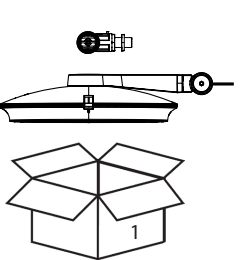

- 1x [Screw]
- 1x 1x 1x 1x [Washer, Nut, Washer, Washer]
- 1x [Washer]

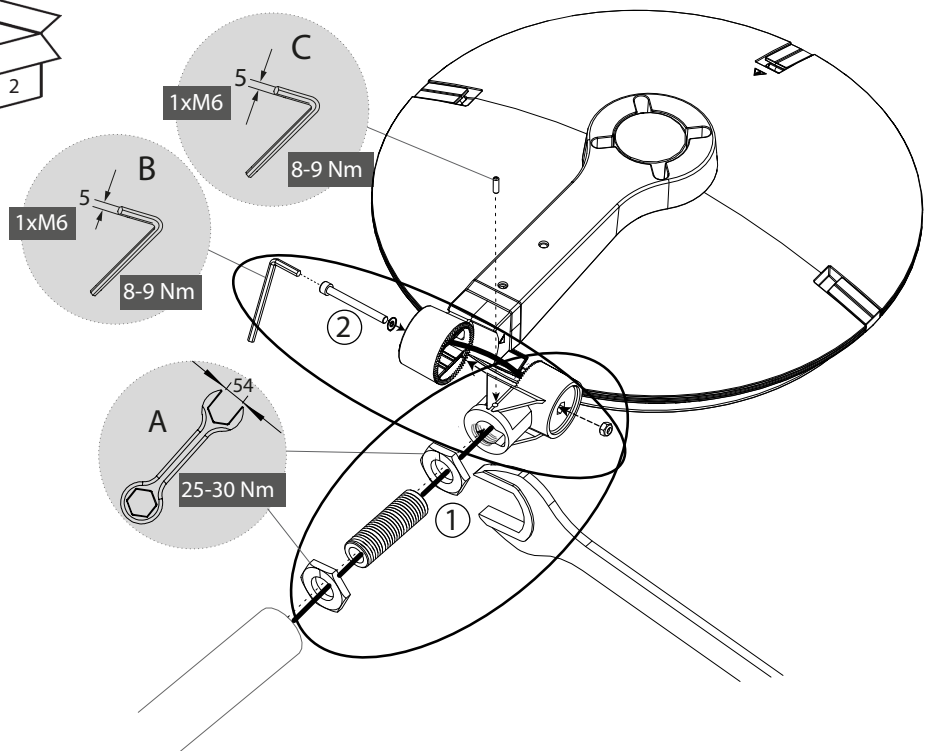

F

DIRECT ON WALL

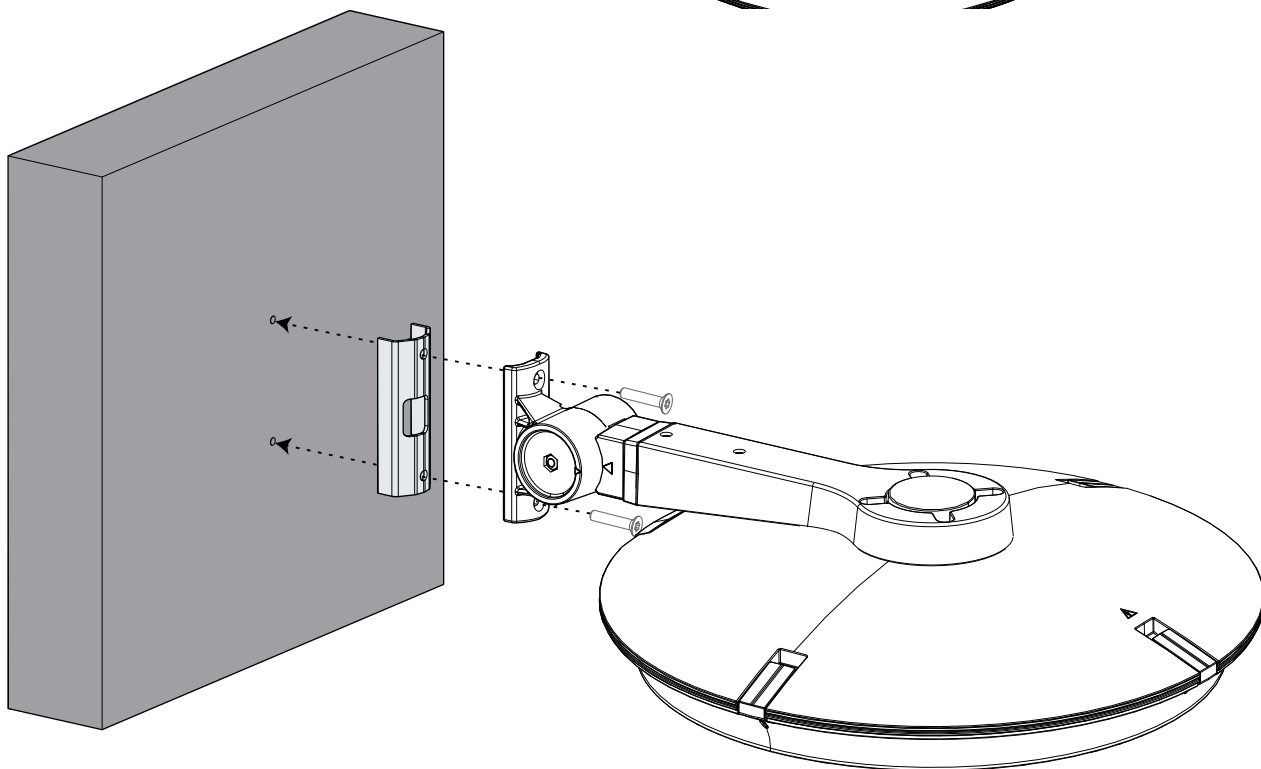
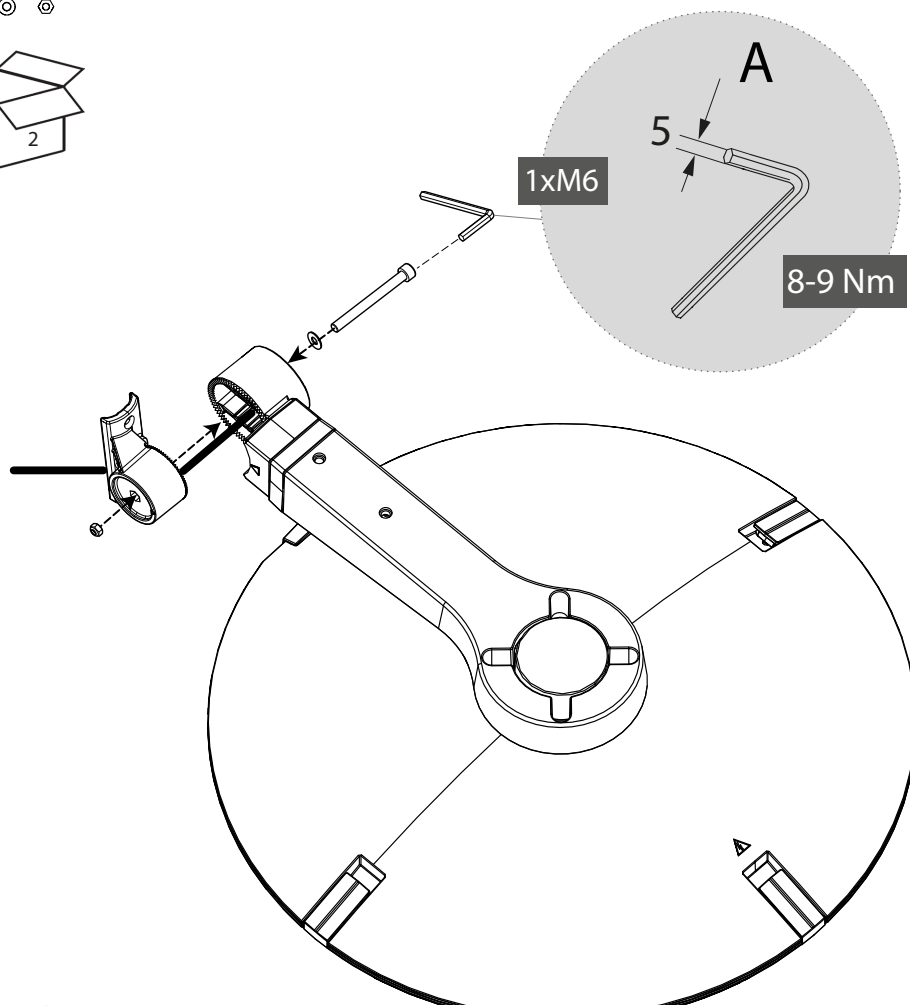
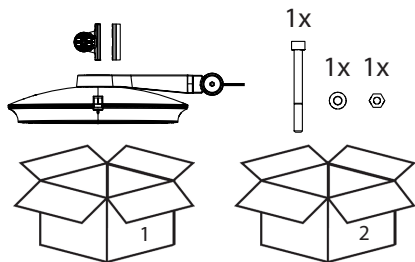

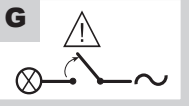
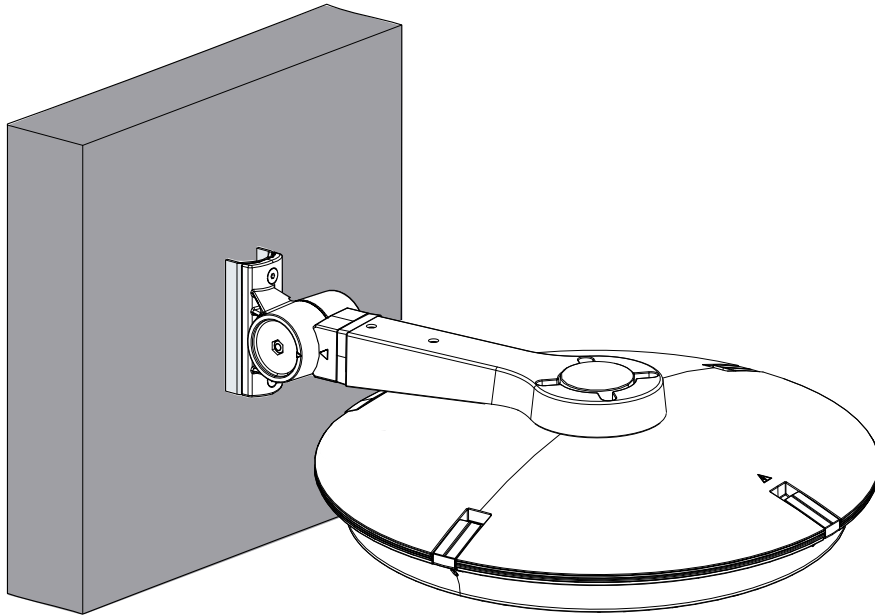

DIRECT ON POLE

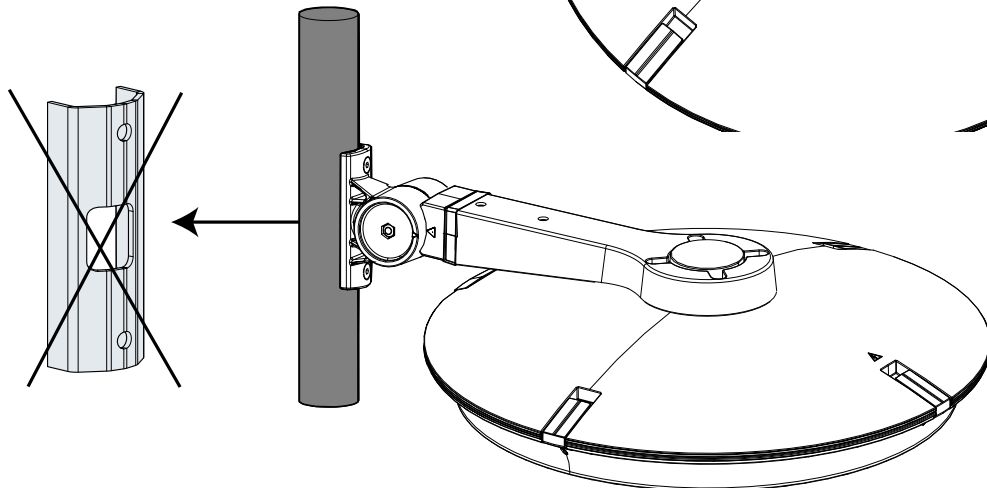
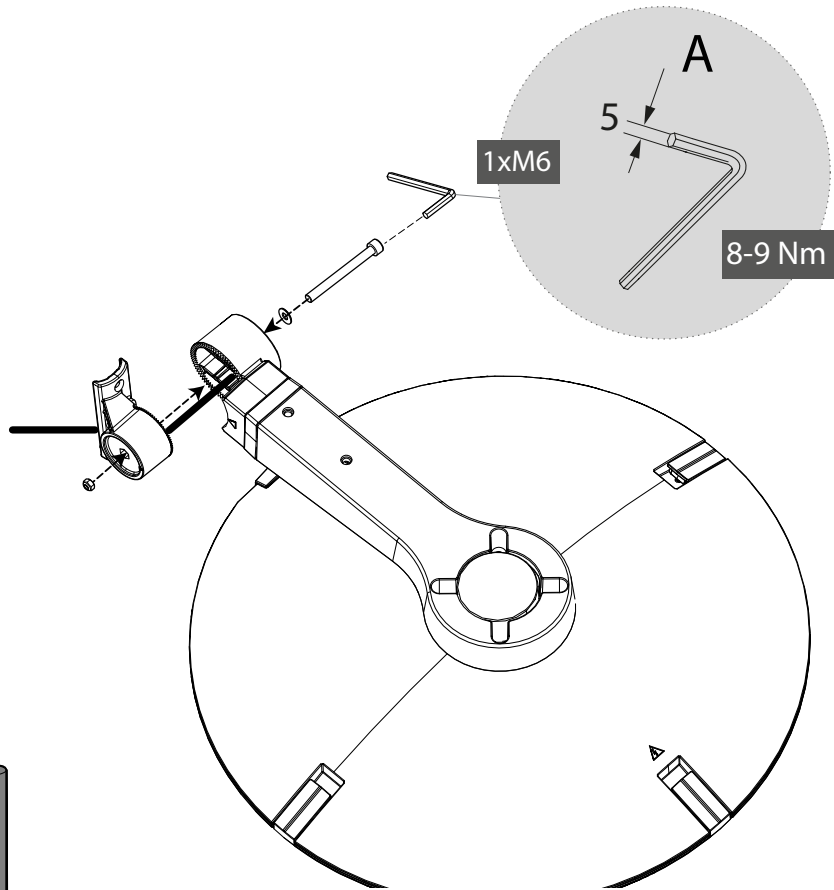
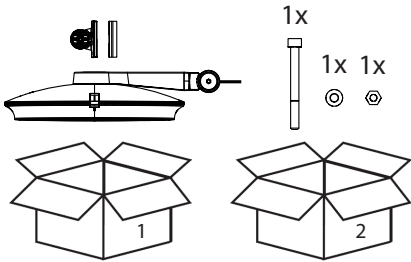

H

MAINTENANCE (CR-KIT EU)

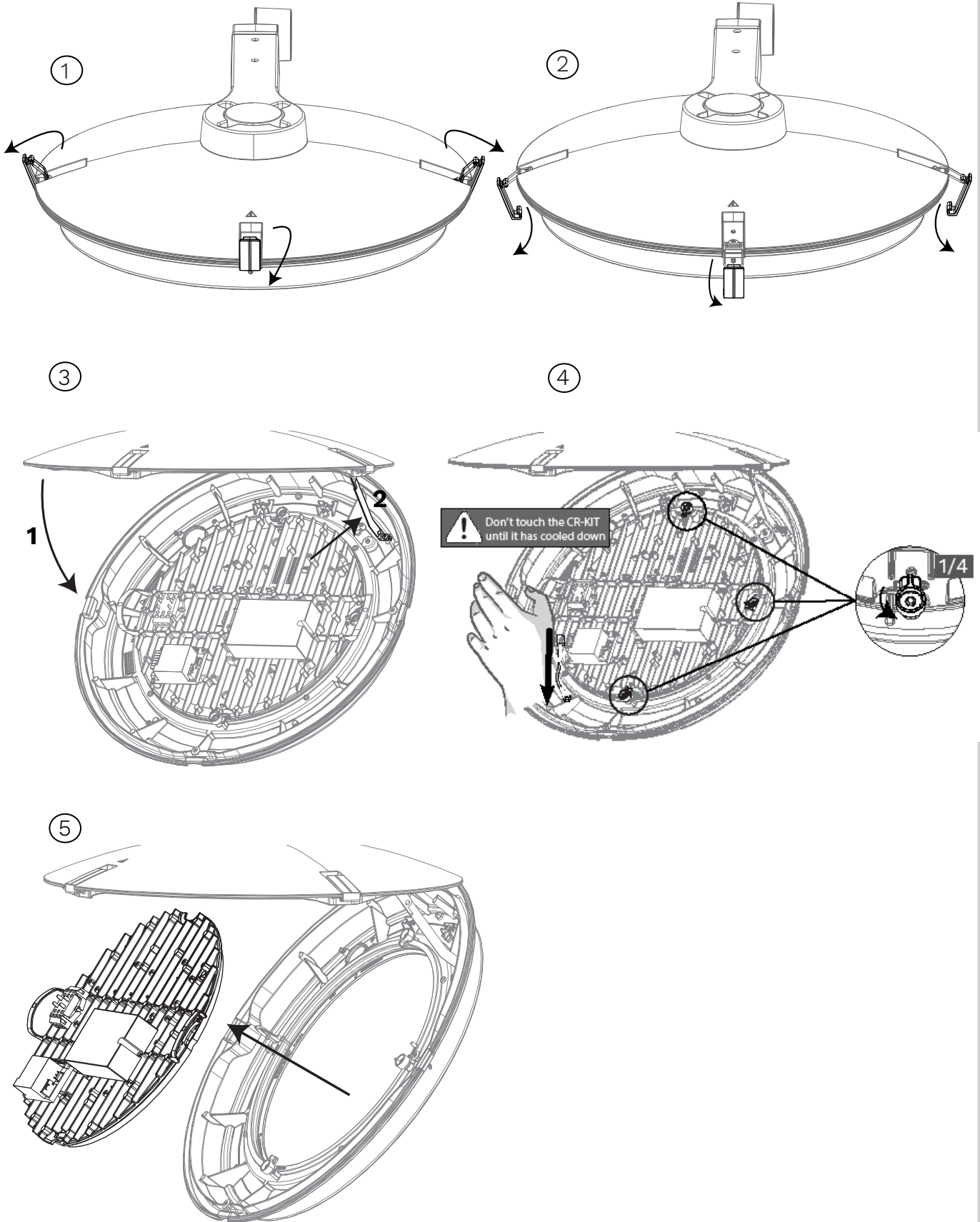

REASSEMBLING



①

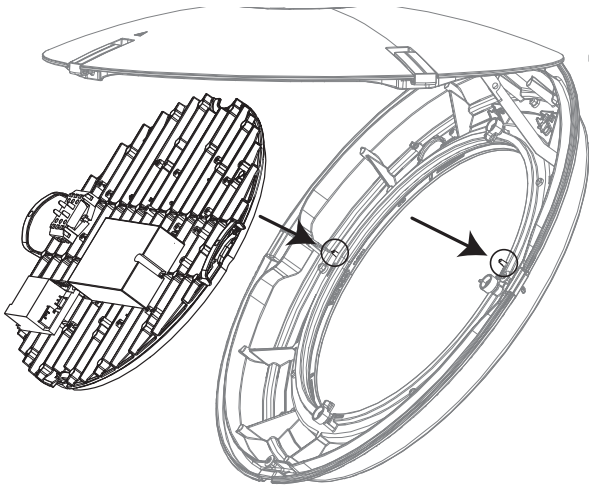

②

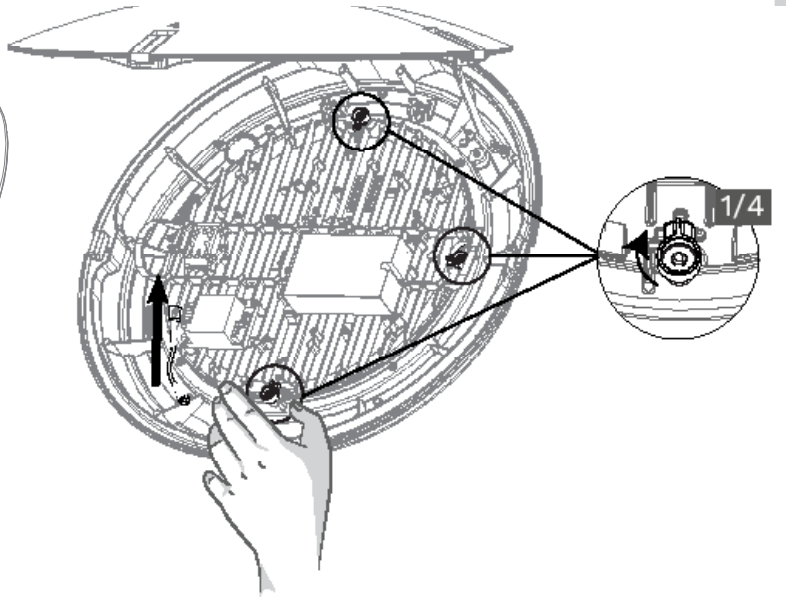

③

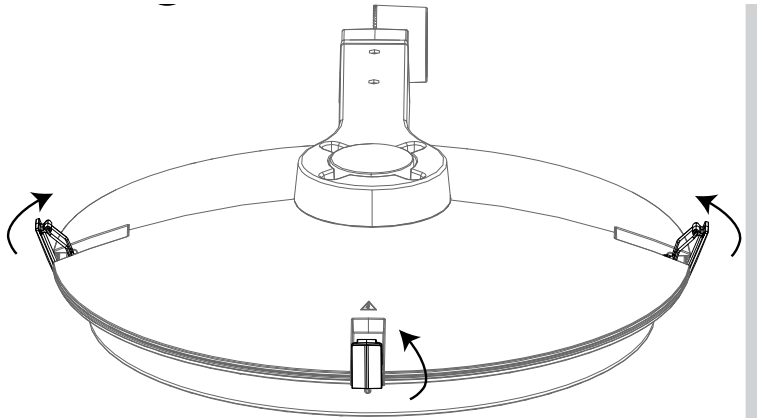
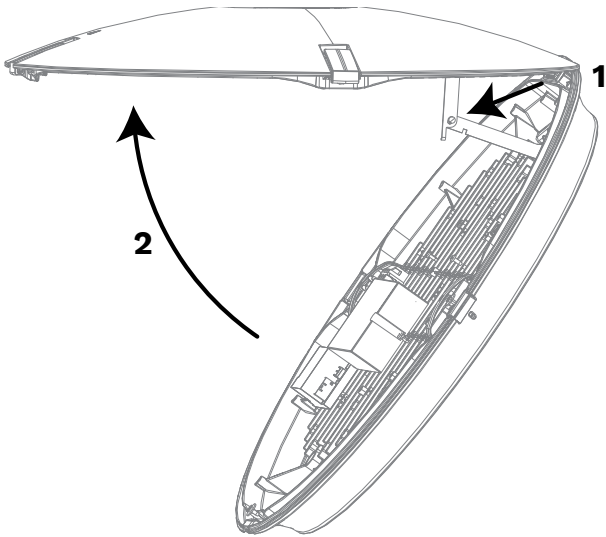

⑤

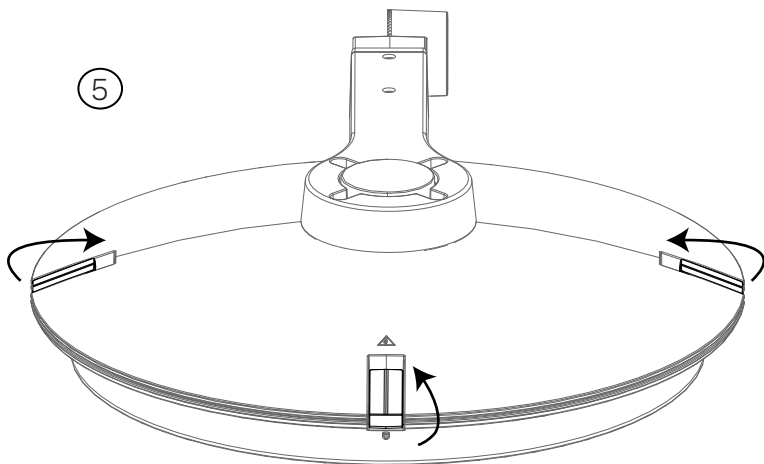

H

MAINTENANCE (CR-KIT CSA/UL)

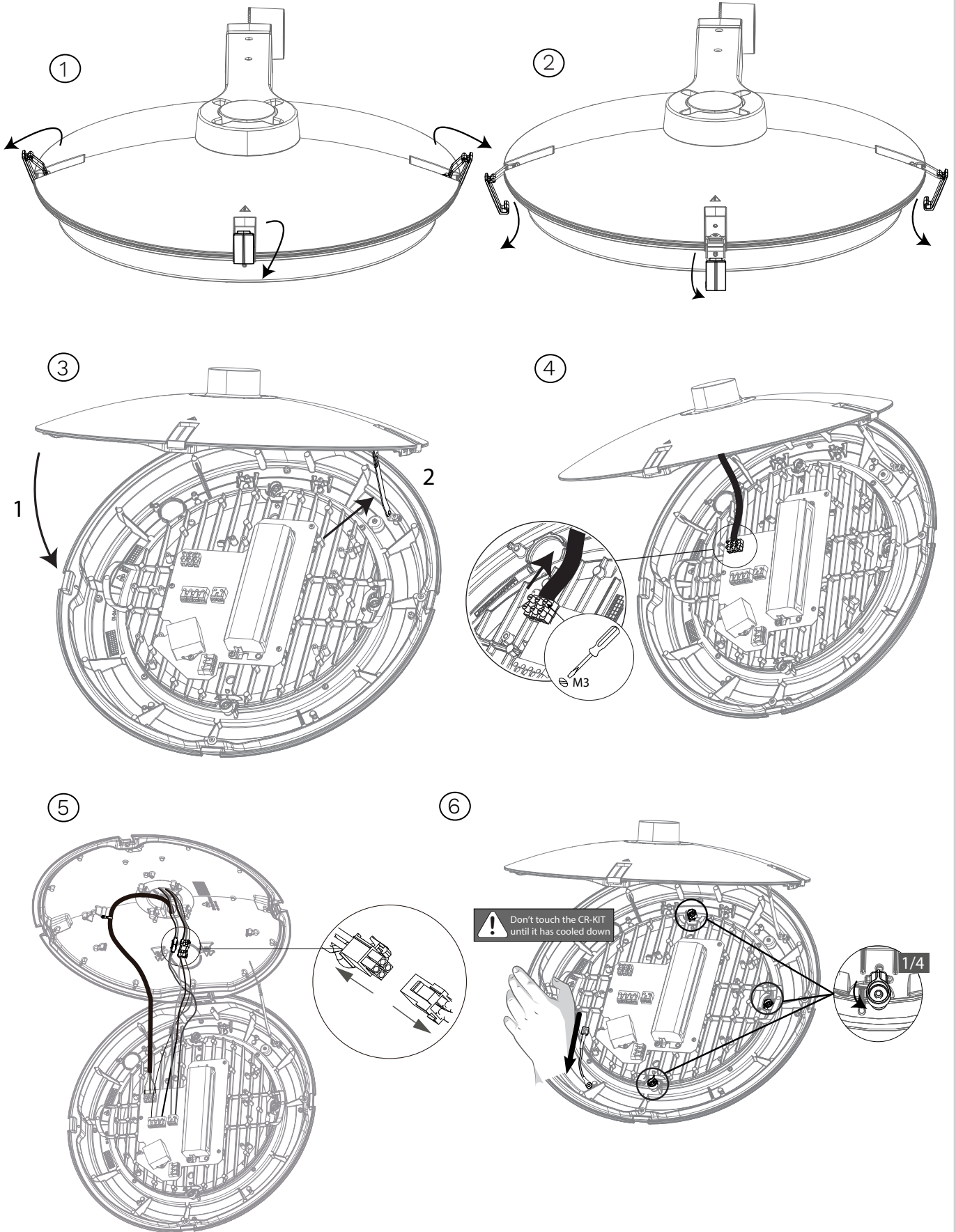

REASSEMBLING

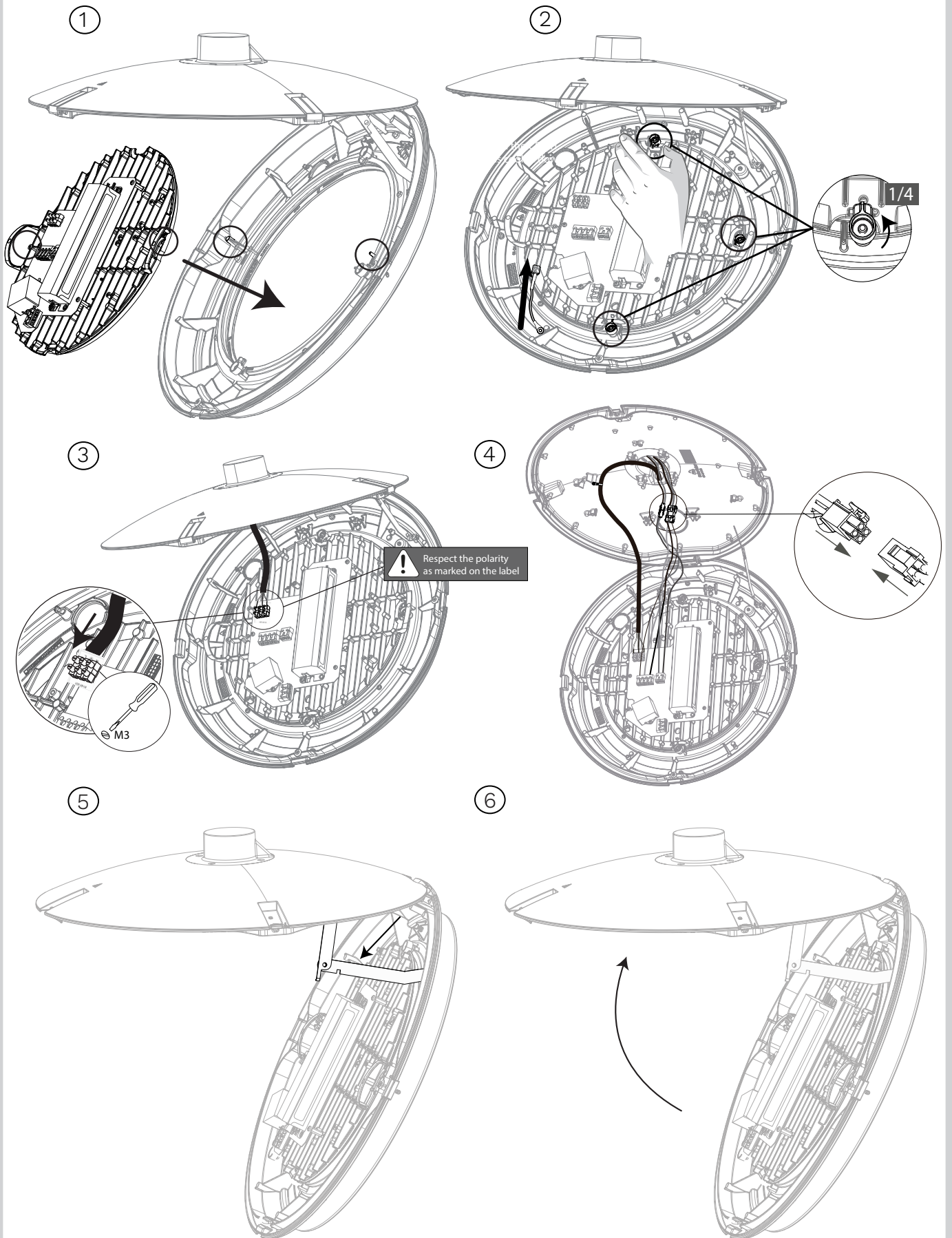

REASSEMBLING



7

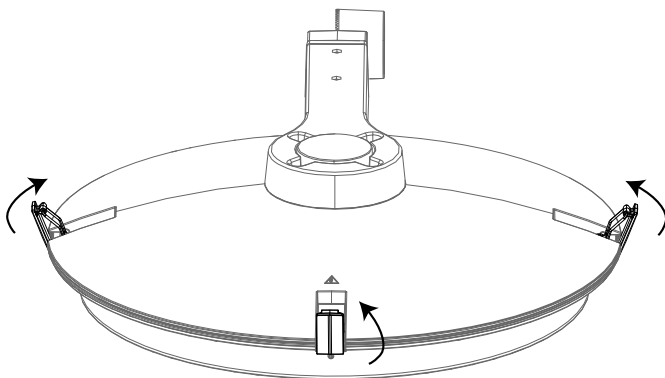

8

